



BALANCERS



INGERSOLL-RAND BALANCERS

With more than 50 models to choose from, there's an Ingersoll-Rand balancer to satisfy virtually any balancing requirement. These balancers are ruggedly built of die cast aluminum for strength and reduced weight. They feature easy-to-use controls that allow for accurate spring adjustment.

BALANCERS

BALANCERS FROM INGERSOLL-RAND

- 50 models to choose from
- Five different series to meet all balancing requirements
- Lifts ranging from five to nine feet
- Covers weight balancing needs from one to 363 pounds
- Made of rugged die cast aluminum
- Safety locking device on medium, heavy, and super-duty models prevents dropping of the tool should the spring fail
- Easy-to-use controls allow for accurate spring adjustment

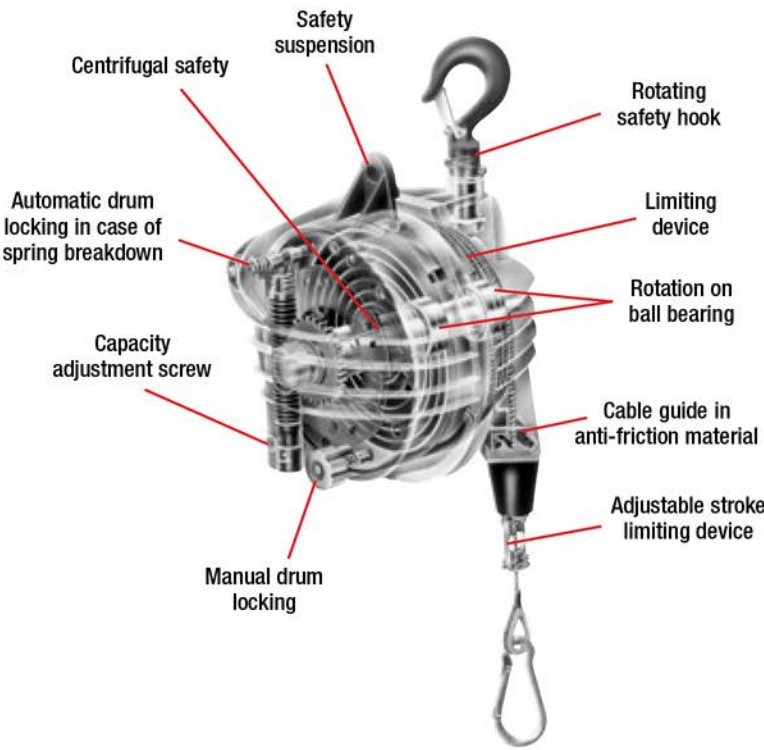

B	M	D	L	L	—	10
Balancer	L = Light M = Medium I = Intermediate H = Heavy S = Super	D = Duty R = Hose reel	L = Long cable (8.2' or 9.85') S = Short cable (6.5')	Locking type (Pull to set – pull again to release)	Upper weight capacity in kilograms	

BALANCERS

Hose Reel Balancers

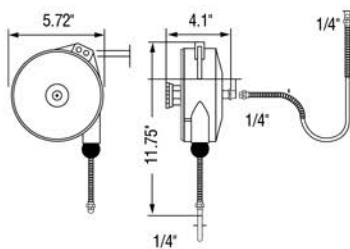
BHR-15

BHR Series

Part Number	Hose Nipple Size	cfm Extended	Capacity lb (kg)	Lift ft (mm)
Hose Reel Balancers — 0.875 – 5.5 lb Capacity				
BHR-8	1/4"	18.4	0.875 – 1.75 (0.397 – 0.794)	4.25 (1295)
BHR-15	1/4"	18.4	1.5 – 3.33 (0.68 – 1.51)	4.25 (1295)
BHR-25	1/4"	18.4	2.625 – 5.5 (1.191 – 2.495)	4.25 (1295)

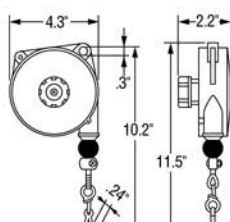
Light-duty Balancers

BLD1

BLD Series

Part Number	Capacity lb (kg)	Weight of Balancer lb (net-kg)	Lift ft (mm)
Light-duty Balancers — 0.9 – 6.6 lb Capacity			
BLD1	0.9 – 2.2 (0.4 – 1)	1.3 (0.6)	5.2 (1600)
BLD2	2.2 – 4.4 (1 – 2)	1.3 (0.6)	5.2 (1600)
BLD3	4.4 – 6.6 (2 – 3)	1.3 (0.7)	5.2 (1600)

- Rotary hook
- Self-lubricating bushings
- Adjustable capacity and stroke limiting device
- Auxiliary safety suspension

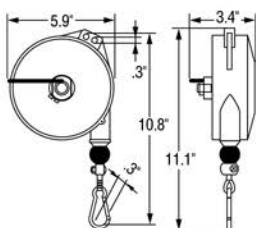
Medium-duty Balancers

BMDS-2

BMDS Series

Part Number	Capacity lb (kg)	Weight of Balancer lb (net-kg)	Lift ft (mm)
Medium-duty Balancers — 2.2 – 30 lb Capacity			
Short Cable			
BMDS-2	2.2 – 5.5 (1 – 2.5)	4.4 (2)	6.5 (2000)
BMDS-4	4.4 – 8.8 (2 – 4)	4.4 (2)	6.5 (2000)
BMDS-6	8.8 – 13.2 (4 – 6)	5.1 (2.3)	6.5 (2000)
BMDS-8	13.2 – 17.6 (6 – 8)	5.5 (2.5)	6.5 (2000)
Long Cable			
BMDL-4	4.4 – 8.8 (2 – 4)	6.4 (2.9)	8.2 (2500)
BMDL-6	8.8 – 13.2 (4 – 6)	7.1 (3.2)	8.2 (2500)
BMDL-8	13.2 – 17.6 (6 – 8)	7.7 (3.5)	8.2 (2500)
BMDL-10	17.6 – 22 (8 – 10)	8.2 (3.7)	8.2 (2500)
BMDL-12	22 – 26.5 (10 – 12)	8.8 (4)	8.2 (2500)
BMDL-14	22 – 30 (10 – 14)	5.6 (2.5)	8.2 (2500)
BMDL-14-Y (Yellow)	22 – 30 (10 – 14)	5.6 (2.5)	8.2 (2500)

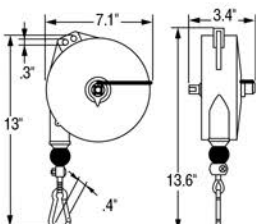
Medium-duty Locking Balancers

BMDLL-10

BMDL / BMDLL Series

Medium-duty Locking Balancers — 4.4 – 22 lb Capacity			
Long Cable			
BMDLL-4	4.4 – 8.8 (2 – 4)	6.6 (3)	8.2 (2500)
BMDLL-6	8.8 – 13.2 (4 – 6)	7.3 (3.3)	8.2 (2500)
BMDLL-8	13.2 – 17.6 (6 – 8)	7.9 (3.6)	8.2 (2500)
BMDLL-10	17.6 – 22 (8 – 10)	8.4 (3.8)	8.2 (2500)

- Safety device prevents dropping of load due to spring breakage (except BMDS-2)
- Anti-friction cable guide
- Adjustable stroke limiting device



BALANCERS

Intermediate-duty Balancers



BIDS-10

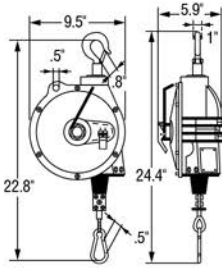

BIDS Series

Part Number	Capacity lb (kg)	Weight of Balancer lb (net-kg)	Lift ft (mm)
Intermediate-duty Balancers — 8.8 – 55 lb Capacity			
BIDS-7	8.8 – 15.4 (4 – 7)	5 (2.26)	6.5 (2000)
BIDS-10	15.4 – 22 (7 – 10)	5.5 (2.49)	6.5 (2000)
BIDS-14	22 – 30.8 (10 – 14)	5.5 (2.49)	6.5 (2000)
BIDS-18	30.8 – 39.6 (14 – 18)	6.5 (2.95)	6.5 (2000)
BIDS-22	39.6 – 48.4 (18 – 22)	6.5 (2.95)	6.5 (2000)
BIDS-26	48.4 – 55 (22 – 25)	6.5 (2.95)	6.5 (2000)

- Safety device prevents load dropping due to spring breakage
- Anti-friction cable guide
- Adjustable stroke limiting device
- Upper rotary suspension
- Safety hook
- Auxiliary safety suspension

Heavy-duty Balancers



BHD-35

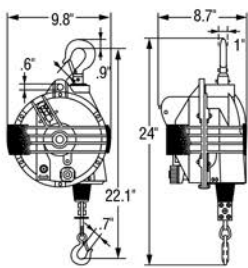

BHD Series

Part Number	Capacity lb (kg)	Weight of Balancer lb (net-kg)	Lift ft (mm)
Heavy-duty Balancers — 22 – 143 lb Capacity			
BHD-15	22 – 33 (10 – 15)	22.7 (10.3)	6.5 (2000)
BHD-20	33 – 44 (15 – 20)	23.4 (10.6)	6.5 (2000)
BHD-25	44 – 55 (20 – 25)	24.7 (11.2)	6.5 (2000)
BHD-30	55 – 66 (25 – 30)	25.4 (11.5)	6.5 (2000)
BHD-35	66 – 77 (30 – 35)	26 (11.8)	6.5 (2000)
BHD-45	77 – 99 (35 – 45)	27.3 (12.4)	6.5 (2000)
BHD-55	99 – 121 (45 – 55)	27.6 (12.5)	6.5 (2000)
BHD-65	121 – 143 (55 – 65)	30 (13.6)	6.5 (2000)

- Safety device prevents load dropping due to spring breakage
- Upper suspension with rotary safety hook
- Precision guided cable winding prevents jamming
- Anti-friction cable guide
- Manual locking device for instant clamping or release
- Worm screw capacity adjustment.
- Spring drum assembly.
- Floor controlled locking device available (BIL-7343)

BALANCERS

Super-duty Balancers



BSD-20

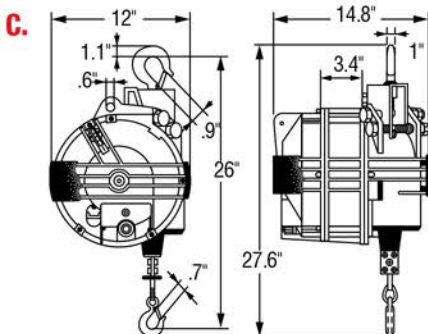
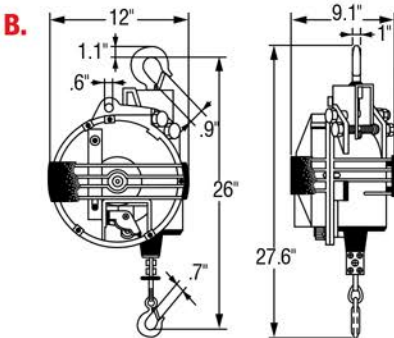
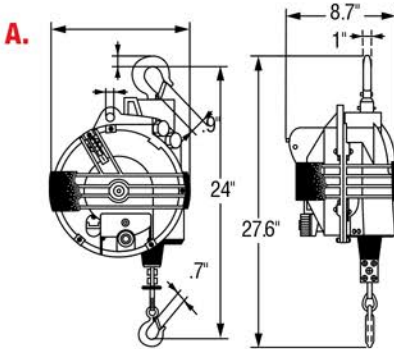

Part Number	Capacity lb (kg)	Weight of Balancer lb (net-kg)	Lift ft (mm)	Diagram
Super-duty Balancers — 33 – 363 lb Capacity				
BSD-20	33 – 44 (15 – 20)	41.9 (19)	8.2 (2500)	A
BSD-30	44 – 66 (20 – 30)	43.7 (19.8)	8.2 (2500)	A
BSD-40	66 – 88 (30 – 40)	45.9 (20.8)	8.2 (2500)	A
BSD-50	88 – 110 (40 – 50)	52.7 (23.9)	8.2 (2500)	A
BSD-60	110 – 132 (50 – 60)	56 (25.4)	8.2 (2500)	A
BSD-70	132 – 154 (60 – 70)	59.1 (26.8)	8.2 (2500)	B
BSD-80	154 – 176 (70 – 80)	61.3 (27.8)	8.2 (2500)	B
BSD-90	176 – 198 (80 – 90)	63.5 (28.8)	8.2 (2500)	B
BSD-100	198 – 220 (90 – 100)	78.5 (35.6)	8.2 (2500)	C
BSD-120	220 – 265 (100 – 120)	85.3 (338.7)	8.2 (2500)	C
BSD-140	265 – 309 (120 – 140)	92.2 (41.8)	8.2 (2500)	C
BSD-150	287 – 330 (130 – 150)	98.1 (44.5)	8.2 (2500)	C
BSD-165	330 – 363 (150 – 165)	106.3 (48.2)	8.2 (2500)	C
Super-duty Balancers — 33 – 330 lb Capacity Long Cable				
BSDL-20	33 – 44 (15 – 20)	42.1 (19.1)	9.85 (3000)	A
BSDL-25	44 – 55 (20 – 25)	43.9 (19.9)	9.85 (3000)	A
BSDL-35	55 – 77 (25 – 35)	46.1 (20.9)	9.85 (3000)	A
BSDL-45	77 – 99 (35 – 45)	52.5 (23.8)	9.85 (3000)	B
BSDL-50	88 – 110 (40 – 50)	52.7 (23.9)	9.85 (3000)	B
BSDL-60	110 – 132 (50 – 60)	55.8 (25.3)	9.85 (3000)	B
BSDL-70	132 – 154 (60 – 70)	58.9 (26.7)	9.85 (3000)	B
BSDL-80	154 – 176 (70 – 80)	61.7 (28)	9.85 (3000)	B
BSDL-90	176 – 198 (80 – 90)	64 (29)	9.85 (3000)	B
BSDL-100	198 – 220 (90 – 100)	81.1 (36.8)	9.85 (3000)	C
BSDL-115	220 – 254 (100 – 115)	85.3 (38.7)	9.85 (3000)	C
BSDL-130	254 – 286 (115 – 130)	88 (39.9)	9.85 (3000)	C
BSDL-140	286 – 309 (130 – 140)	94.4 (42.8)	9.85 (3000)	C
BSDL-150	309 – 330 (140 – 150)	100.6 (45.6)	9.85 (3000)	C

**Higher capacities available upon request.*

- Safety device prevents load dropping
- Upper suspension with rotary safety hook
- Precision guided cable winding prevents jamming
- Anti-friction cable guide
- Manual locking device for instant clamping or release
- Worm screw capacity adjustment
- Alignable rotating upper hook
- Cable replacement without balancer disassembly
- Cable visible for inspection
- Floor controlled locking device available (BIL-3224)

